

10-HEX01X5-OX1

Frequency: Shown Under
AISG by pass: TBD

HEXAPLEXER MULTI-BAND COMBINER

Power Rating: 300W
IM3: ≤155dBc
Connector: Optional
Usage: IP65, Indoor & Outdoor

OVERVIEW

BRIDGE COMBINERS are used to combine two different system signals and output signal from com port. The combiners are integrated with technology to enhance the low PIM, isolation and other key parameters.

KEY FEATURES

- Available in various DC/AISG by pass configurations
- N, Din 4.3-10 connectors, available upon request
- Single or twin type available

ORDERING INFORMATION

Product Picture

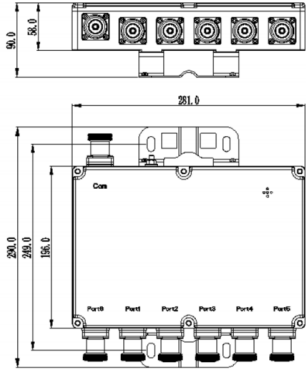

Part Numbers

		Single Unit	Twin Units
Connector Type	4.3-10 Female	10-HEX01E5-OS1	10-HEX01E5-OT1
	DIN Female	10-HEX01C5-OS1	10-HEX01C5-OT1

TECHNICAL DATA

Electrical Specifications

Frequency Range	Band 1	600-960 MHz
	Band 2	1695-1880 MHz
	Band 3	1920-2200 MHz
	Band 4	2300-2400 MHz
	Band 5	2500-2690 MHz
	Band 6	3300-3800 MHz
Insertion loss	Port 1	≤0.5dB
	Port 2	≤0.5dB
	Port 3	≤0.5dB
	Port 4	≤0.5dB
	Port 5	≤0.5dB
	Port 6	≤0.5dB
Isolation		≥ 50dB
VSWR/ Return loss		≤1.25/ - 19dB
PIM : IM3		≤-155dBc
DC/AISG by pass		TBD
Power Rating		300W
Impedance		50Ω

Disclaimer All images are for reference purposes only

Revised: A.1.1

Important Notice: Information contained in this data sheet is believed to be reliable at the date of issue, accuracy and completeness is not guaranteed. Bridge Components holds the right to change the product specifications without notice.

10-HEX01X5-OX1

Frequency: Shown Under
AISG by pass: TBD

HEXAPLEXER MULTI-BAND COMBINER

Power Rating: 300W
IM3: ≤-155dBc
Connector: Optional
Usage: IP67 Indoor & Outdoor



Mechanical Specifications		
Dimensions	Single unit	281 x 196 x 58mm
	Twin unit	281 x 196 x 116mm
Weight	Single unit	3.75kg
	Twin unit	7.5kg
Color		Light-Gray

Environmental Specifications	
Temperature	-10~+65°C
Humidity	≤95%
Lighting Protection	TBD
IP Rating	IP65,Indoor&Outdoor

Installation Specifications	
Installation Method	Wall Mounting
Pole Diameter	N/A